

扣压式软管接头

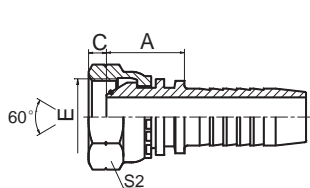

KF22611-OR

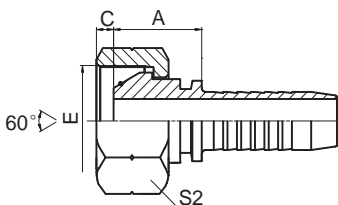

KF22611-ORT

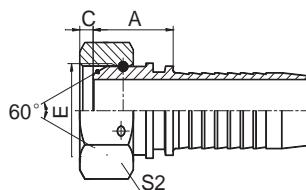

KF22611-ORW

英管内螺纹 60° 外锥面 O 形圈
BSP FEMALE 60° CONE O-RING

代号 PART NO.	螺纹 E THREAD E	胶管 HOSE BORE		尺寸 DIMENSIONS			
		公称内径 DN	标号 DASH	A	C	S2	
KF 22611-02-03OR	G1/8"X28	5	03	15	5.5	14	
KF 22611-02-04OR	G1/8"X28	6	04	15	5.5	14	
KF 22611-04-03OR	G1/4"X19	5	03	17	5.5	19	
KF 22611-04-04OR	G1/4"X19	6	04	18	5.5	19	
KF 22611-04-05OR	G1/4"X19	8	05	18	5.5	19	
KF 22611-04-06OR	G1/4"X19	10	06	18	5.5	19	
KF 22611-06-04OR	G3/8"X19	6	04	19	6.3	22	
KF 22611-06-05OR	G3/8"X19	8	05	19	6.3	22	
KF 22611-06-06OR	G3/8"X19	10	06	19.5	6.3	22	
KF 22611-06-08OR	G3/8"X19	12	08	19.5	6.3	22	
KF 22611-08-06ORT	G1/2"X14	10	06	21	7.5	27	
KF 22611-08-08OR	G1/2"X14	12	08	21.5	7.5	27	
KF 22611-10-08OR	G5/8"X14	12	08	22	9.5	30	
KF 22611-10-10OR	G5/8"X14	16	10	23	9.5	30	
KF 22611-12-08ORT	G3/4"X14	12	08	22	10.9	32	
KF 22611-12-10OR	G3/4"X14	16	10	23.5	10.9	32	
KF 22611-12-12OR	G3/4"X14	20	12	24	10.9	32	
KF 22611-16-12ORT	G1"X11	20	12	24	11.7	41	
KF 22611-16-14OR	G1"X11	22	14	26	11.7	41	
KF 22611-16-16OR	G1"X11	25	16	27	11.7	41	
KF 22611-20-16ORT	G1.1/4"X11	25	16	27.5	11	50	
KF 22611-20-20ORW	G1.1/4"X11	32	20	30.5	11	50	
KF 22611-24-20ORT	G1.1/2"X11	32	20	32	13	55	
KF 22611-24-24ORW	G1.1/2"X11	40	24	32	13	55	
KF 22611-32-24ORT	G2"X11	40	24	30	16	70	
KF 22611-32-32ORW	G2"X11	50	32	31.9	16	70	

注: 1. 表中代号用于编织软管。 2. 如需用于缠绕软管代号改为 22612-xx-xxOR。
Note: 1.For use with braided hoses. 2.If use with spiral hoses, hose fitting series number is 22612-xx-xxOR.